

MOBILE BANKING USER GUIDE

1. Mobile Topup	2
2. eWallet Topup.....	2
3. Prepaid card Topup.....	3

1. Mobile Topup

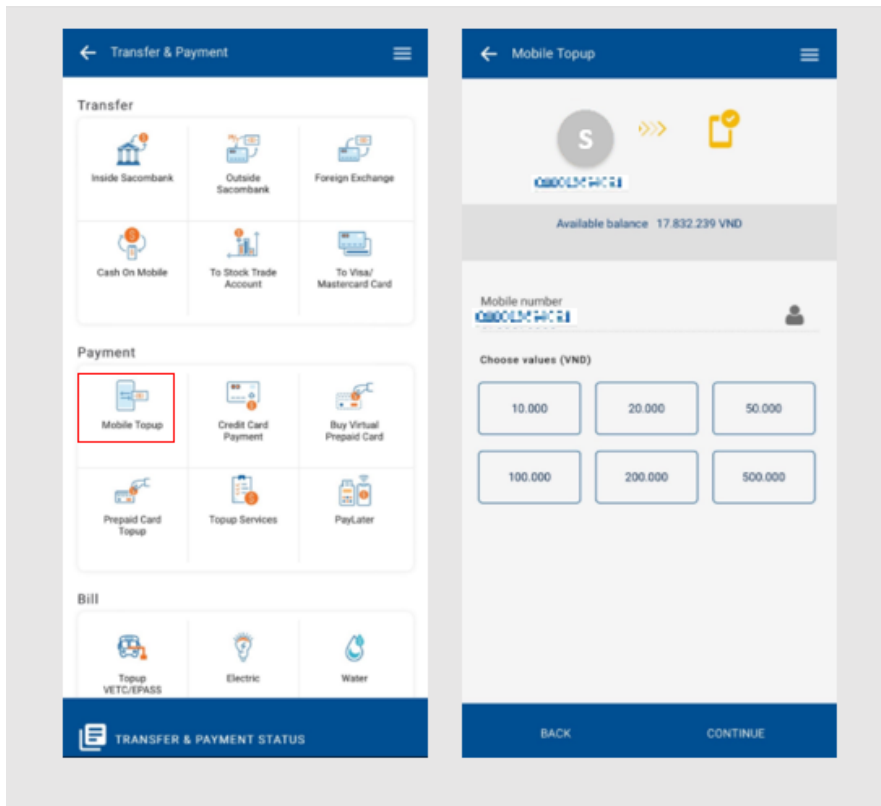

MOBILE TOPUP

Dashboard > Select **Transfer and Payment** or Open **Menu** > Select **Mobile TopUp**

1. Input/choose **Mobile number**
2. Choose **value**
3. Click **Continue** to go to the authentication screen and complete the transaction.

2. eWallet Topup

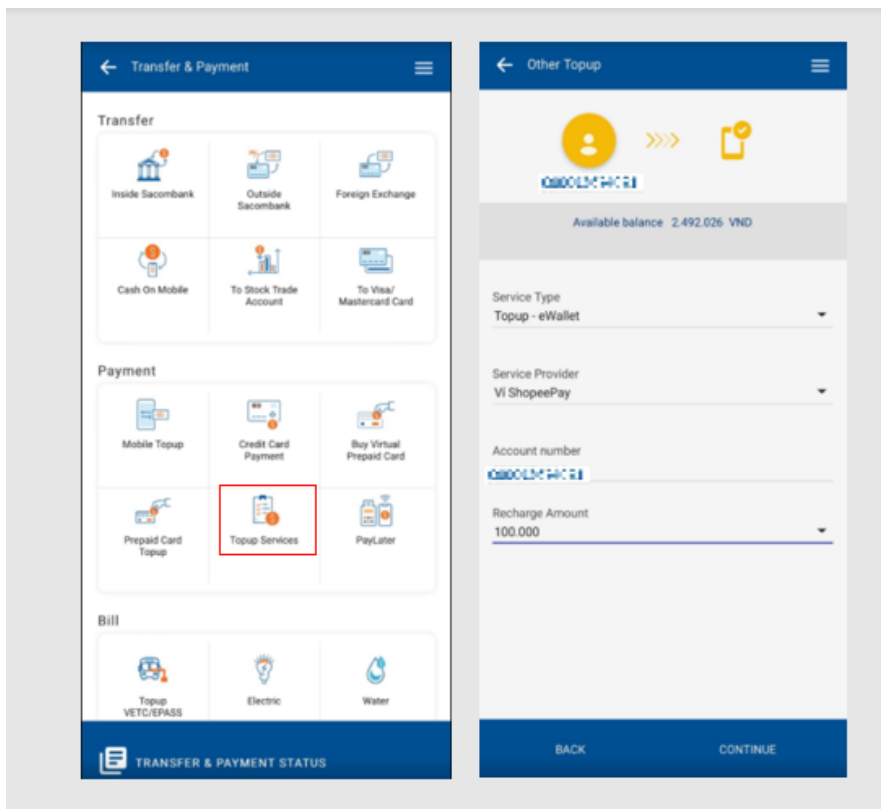

EWALLET TOPUP

Dashboard > Select **Transfer and Payment** or Open **Menu** > Select **TopUp Service**

1. Select **Service Type**
2. Select **Service Provider**
3. Input/ Select **Recharge amount**

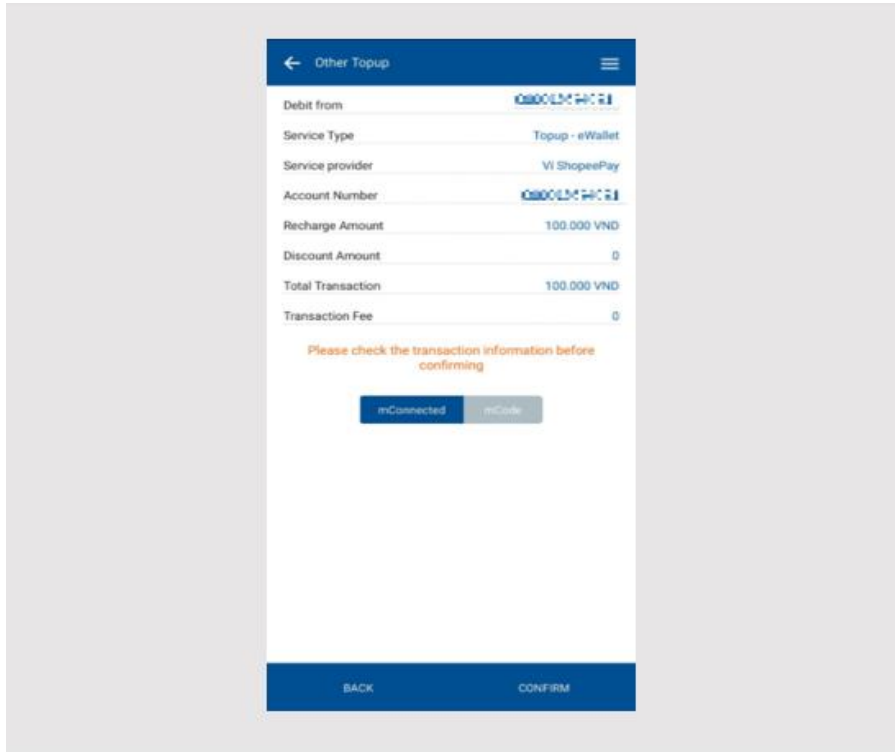

EWALLET TOPUP

4. Check Information
5. Click **Continue** to go to the authentication screen and complete the transaction.

3. Prepaid card Topup

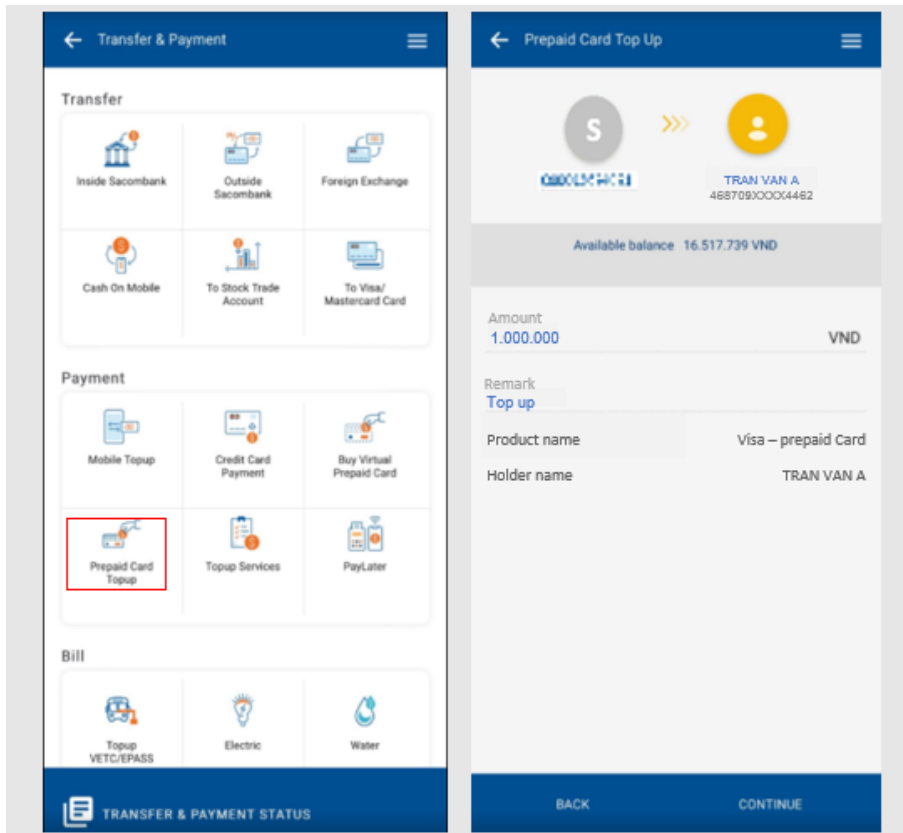

PREPAID CARD TOPUP

Dashboard > Select **Transfer and Payment** or Open **Menu** > Select **Prepaid Card Topup**.

At Detail transaction screen:

1. Select Account/ Card
2. Enter/choose **Prepaid card**
3. Input **Amount** and **Remark**
4. Click **Continue** to go to the authentication screen and complete the transaction. Click **Cancel** to skip the transaction, return to the **Transfer and Payment**